

Safe
money
SMART

Installation guide

index

1.General informations.....	1
2.Safety instructions and regulations.....	2
2.1 Skills.....	3
2.2 Cables.....	3
2.3 Temperature ranges.....	3
2.4 Weight and modules.....	3
3.Product presentation.....	4
4.Product dimensions.....	5
5.Parts included.....	6
6.Preparing for installation.....	7
6.1 recessed positioning.....	8
6.1 recessed positioning.....	9
7.Installation.....	10
7.1 positioning of the fixing template.....	10
7.2 removal of internal modules.....	10
7.3 fixing the case to the floor.....	11
7.4 connections.....	11



1. General information

We thank our users for choosing a Ditron product, for further information and details visit the website www.ditron.eu

SAVE THESE INSTRUCTIONS.

This manual contains important instructions to follow during installation and maintenance.

The SafeMoney Smart has been specially designed to ensure easy installation, even under existing benches. However, you may need to make some modifications to the desk in order to access the internal modules and coin chute.

This guide also provides the instructions necessary to perform these modifications and install the note and coin devices.

SafeMoney Smart is designed for use in dry, indoor environments only.

The manufacturer cannot be held responsible under any circumstances for any damage or loss resulting from improper use of the device.



Incorrect installation of this product, other than as specified in the installation instructions, may result in injuries and malfunctions.

2. Safety instructions and regulations

Installation and removal

The installation and removal of the device and its modules must be carried out exclusively by expert personnel.

Warning:

Before carrying out any removal or maintenance work, ensure that the power supply has been disconnected.

Warning:

When installing SafeMoney Smart, ensure that the modules are securely attached to the internal frame of the system to prevent them from falling or tipping over.

Warning:

Maintenance and management of this equipment must be carried out only by expert personnel with sufficient training or experience in the technology of the appliance and with adequate knowledge of the system.



The SafeMoney Smart complies with the following community standards for electrical safety and electromagnetic compatibility and is CE certified:

- EN 61000-6-1: 2019
- EN 61000-6-3: 2007 + A1
- EN 61000-3-2: 2019
- EN 61000-3-3: 2013+A1
- EN 62368-1:2020+A11
- EN 62233

2. Safety instructions

2.1 Skills

Personnel working on equipment, machinery or electrical systems must be adequately qualified. The degree of competence required for individual interventions depends on their complexity and the level of knowledge required.

Personnel who are not competent must be prohibited from carrying out any intervention unless it is carried out under the supervision of a competent technician.

2.2 Cables

⚠ The SafeMoney Smart is equipped with internal batteries for "operation closure".

It is recommended to connect it to a UPS unit, to have greater autonomy in the event of a power failure.

ⓘ The power cable is included in the packaging.

2.3 Temperature ranges

Operating temperature

The standard ambient temperature must be between 0° + 40°C

Storage temperature

From -15° + 40°C

Operating humidity

[5%, 95%] In the absence of condensation

Storage humidity

[5%, 95%] In the absence of condensation

2.4 Weight and modules *(empty)*

Houses without cash management devices Kg: 29.7

Case with Smart coin system + NV200 Kg: 37.0

Cash handling devices NV200

Spectral module Kg: 3.2 SMART

Coin System module Kg: 4.1

3. Product presentation

- 1 - coin acceptor
- 2 - integrated space for fiscal printer
- 3 - hard reset
- 4 - 10.1" adjustable touchscreen display
- 5 - banknote acceptor
- 6 - coin dispenser
- 7 - front door opening lock
- 8 - rear connection panel
- 9 - banknote management module
- 10 - coin management module
- 11 - cashbox for coin storage

- 12 - front adhesive frame
- 13 - fan

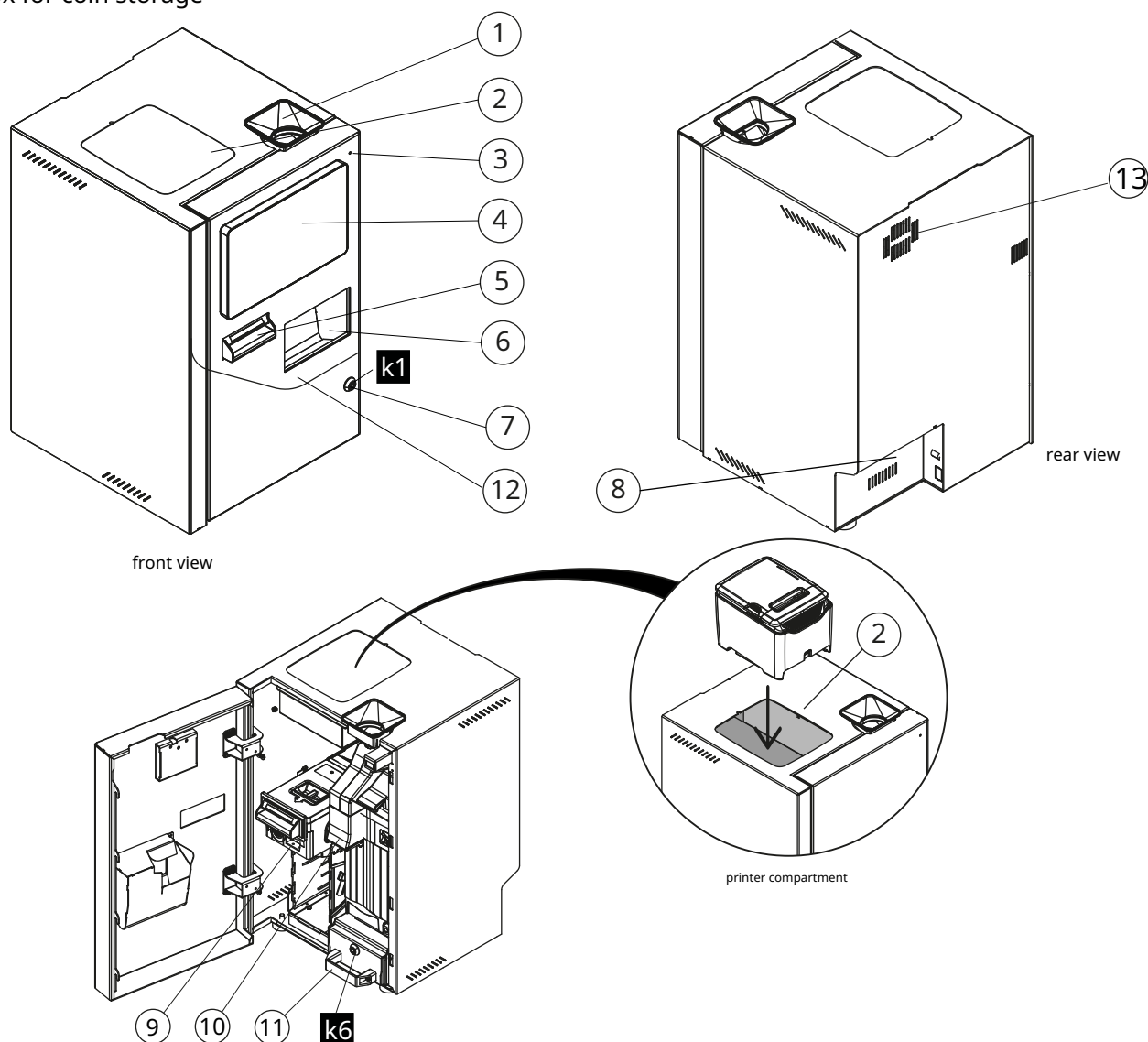

LOCKS

- k1: door
- k2: cashbox extraction
- k3: Smart coin system block
- k4: coin acceptor
- k5: cashbox opening
- k6: extraction of excess coin coin storage

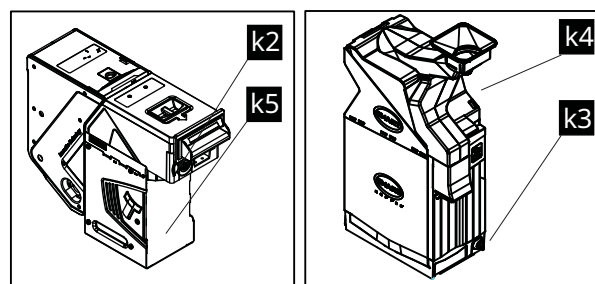

4. Product dimensions

SIDE VIEW

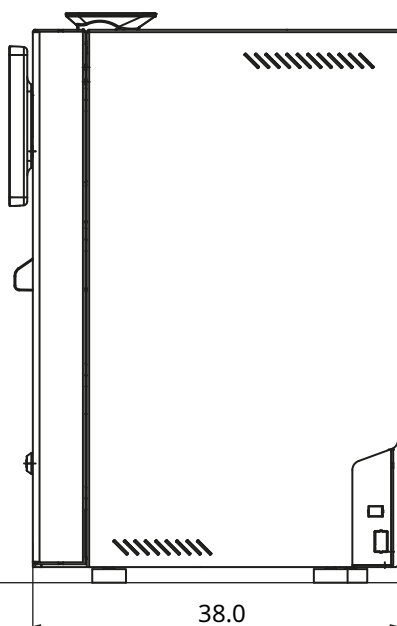

FRONT VIEW

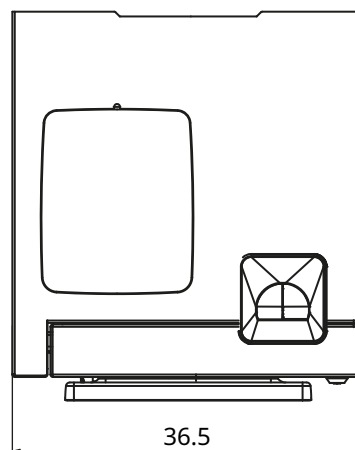
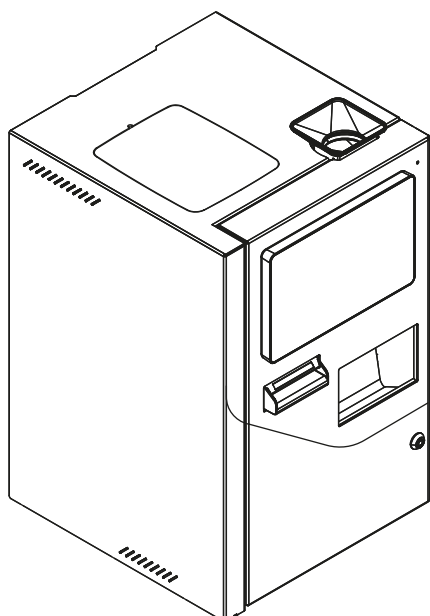
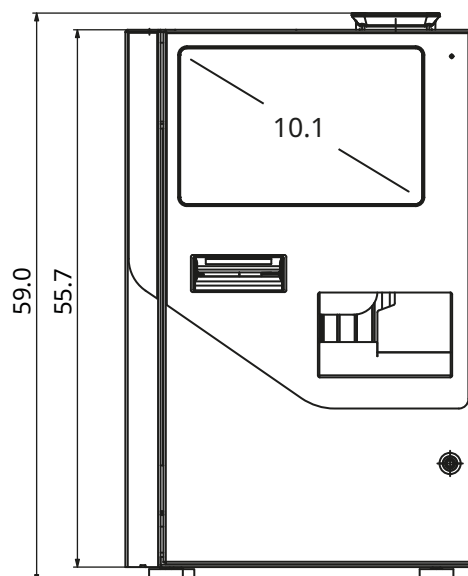

TOP VIEW

5. Parts included

- 1 - Safemoney assembly
- 2 - keys
- 3 - cables
- 4 - Safemoney “shield” sticker
- 5 - activation module
- 5- mounting fixture
- 6- quick installation guide

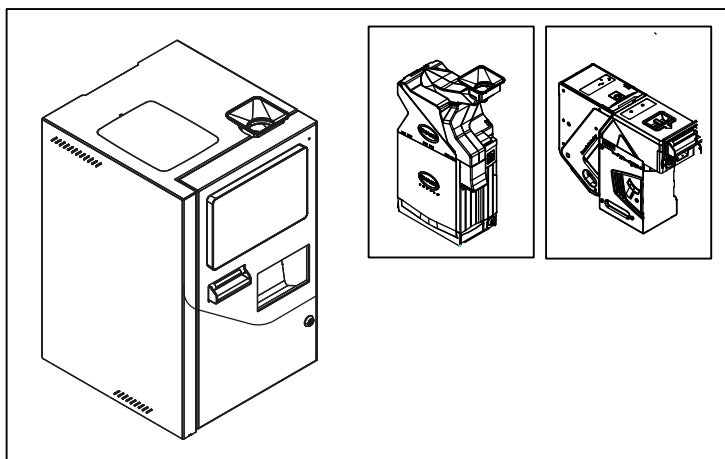

6. Preparing for installation



Measure the existing bench and surrounding area to ensure correct positioning, referring to the dimensions on pages. 5.



Check that there is enough space to accommodate the case, and that there is sufficient space for ventilation.



To avoid hindering the extraction of the internal modules and facilitating product maintenance, allow the door to be opened completely (min. 105°).



Check that the case is positioned on a perfectly horizontal base, the inclination of the product can cause malfunctions of the modules.



Check that the supporting surface is able to support the weight of the fully loaded automatic pay station.



Examine the material of the support surface.
To ensure perfect anchoring of the case to the work surface, 4 holes must be drilled.



Some materials may not be suitable to support the weight and/or fastening.



Check that there are power outlets within a reasonable distance of the cash machine and that the use of any extension cords does not constitute a safety hazard.



Check that the POS system is a reasonable distance from the cash machine and that the USB cable required for communication between the POS and the cash machine can be safely routed and secured.



Inform the shopkeeper of the essential interventions on the existing counters, specifying the consequent creation of dust and waste materials.



For correct use of the Easy automatic cash register, make sure that the base is at least 40cm from the floor.

6. Preparing for installation

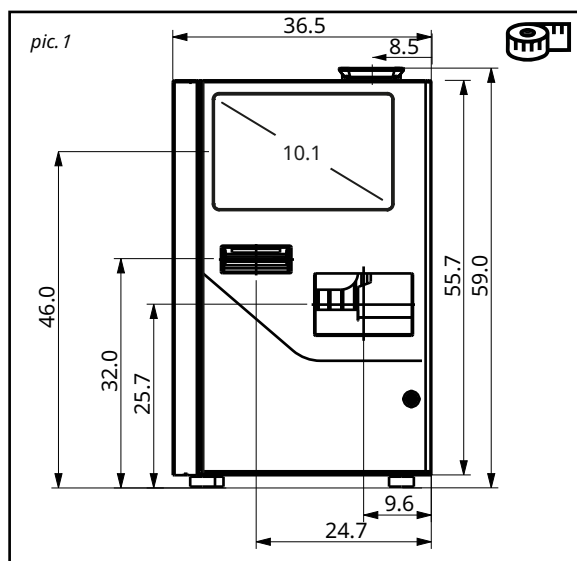

6.1 Built-in positioning

The SafeMoney Smart has also been designed to be installed under the pre-existing counter, with the peripherals facing the customer or operator.

To ensure correct installation inside the workbench, some requirements are essential to ensure adequate ventilation of the device and correct use by the operator (or user).

⚠ It is recommended to connect the cables to the panel and route them, in case it is difficult to reach them later.

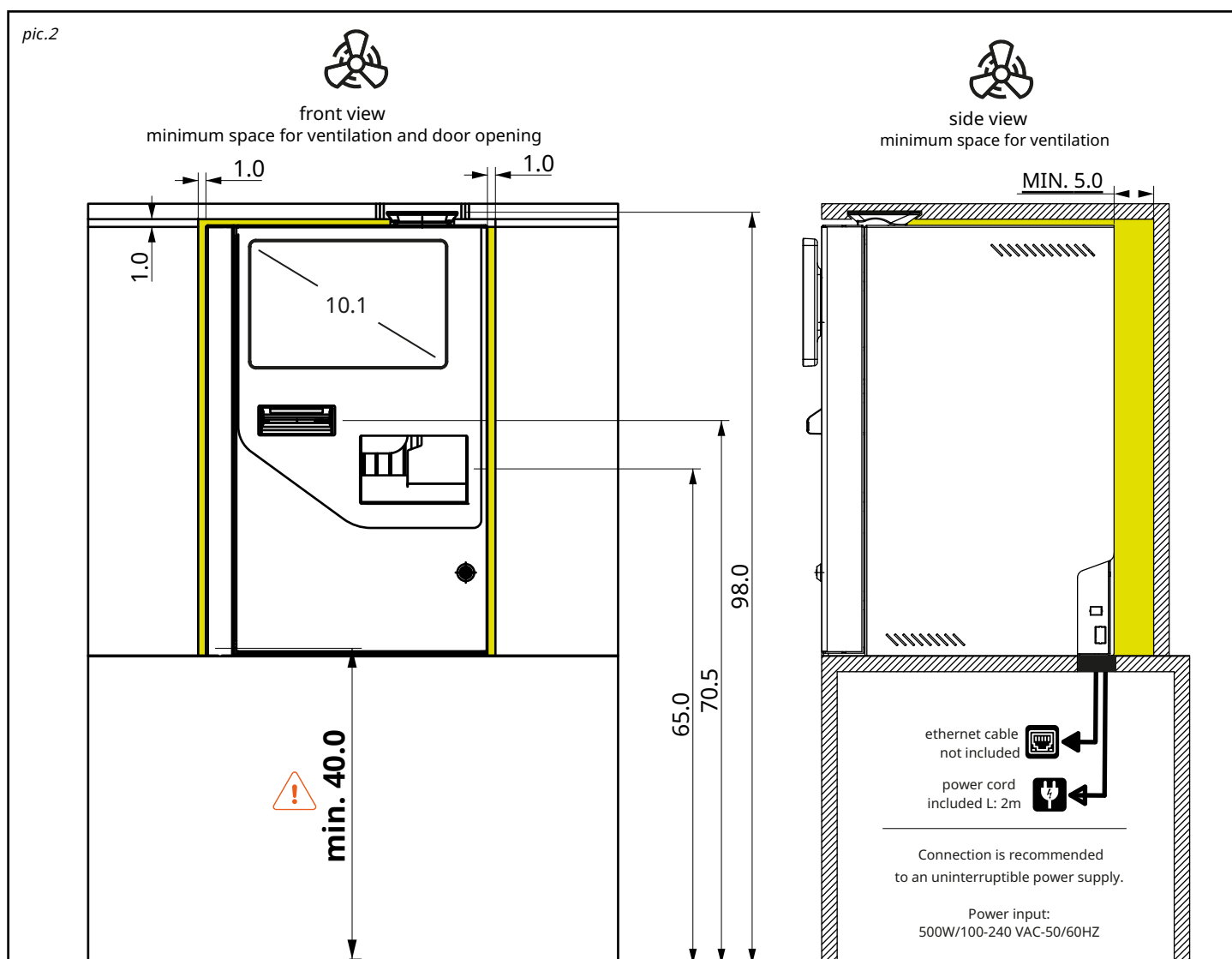

graphic representation, for illustrative purposes only, measurements expressed in "cm"

6. Preparing for installation

ATTENTION

To avoid hindering the extraction of the internal modules and facilitating product maintenance, allow the door to be opened completely, as in pic. 3 (min. 105°).

If you want to completely recess the case, do not cover the coin chute. Evaluate the work to be carried out.

In pic.4, example of a flat edge buttonhole.

min. dimensions: 14.0cm x 11.0cm

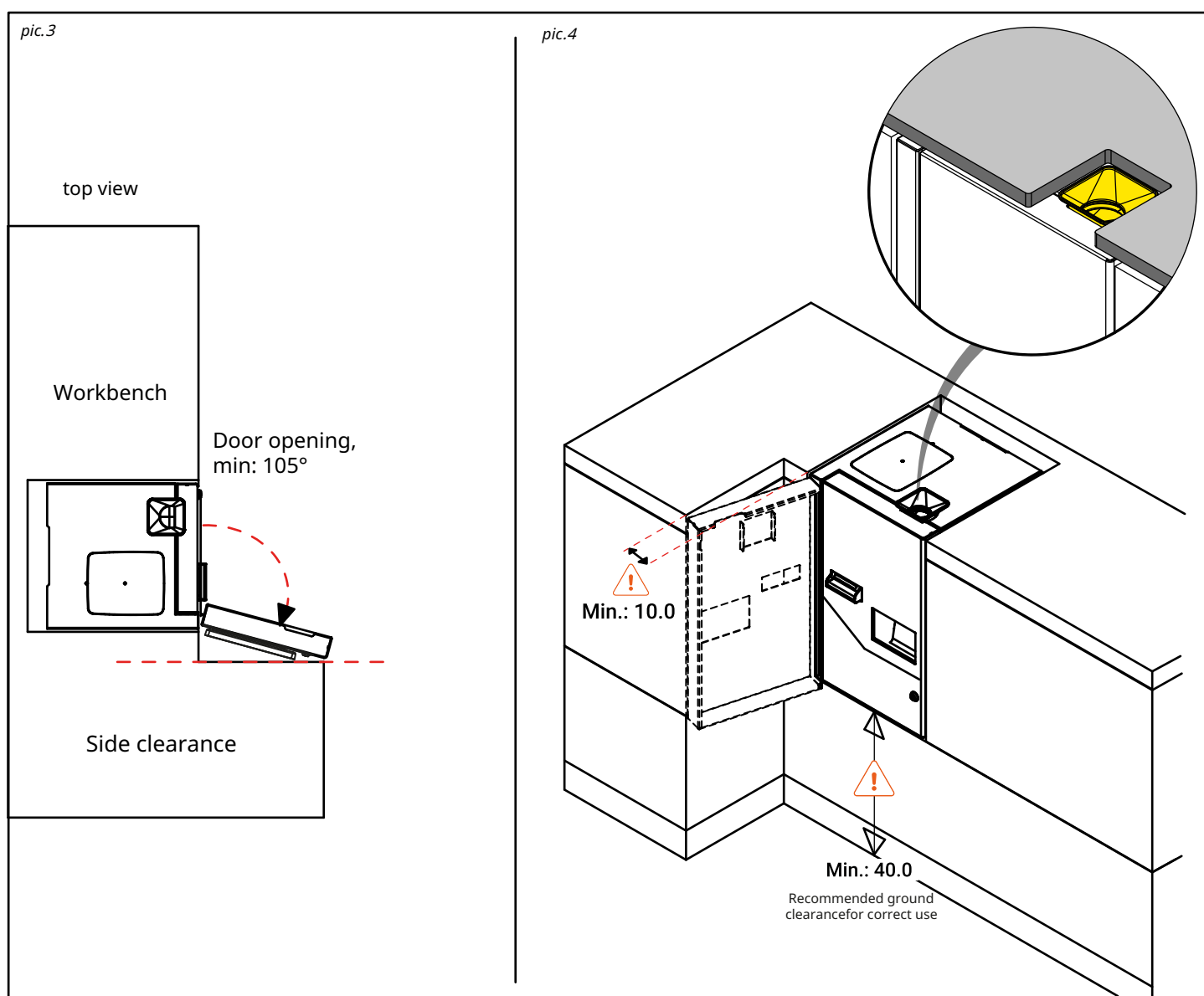

graphic representation, for illustrative purposes only, measurements expressed in "cm"

7. Installation

Remove the unit from the packaging and after checking the points in the "preparation for installation", proceed with the installation.

For greater safety it is possible to fix the automatic cash register to the support surface; in this case, we recommend carrying out the operation with the fixing template supplied.

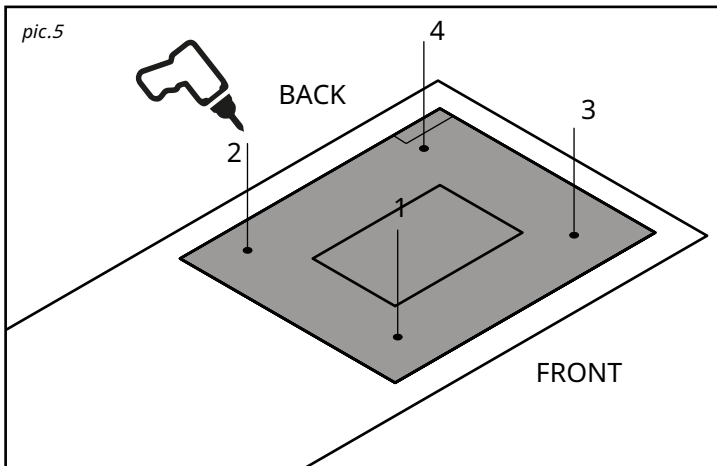

7.1 Template for fixing holes

Place the template on the surface and, using a drill, make the 4 holes for fixing.

Pay particular attention to the direction indicated on the template. (FRONT / BACK)

If necessary, create a slot for the passage of the cables, referring to the position of the "connection panel" indicated on the template.

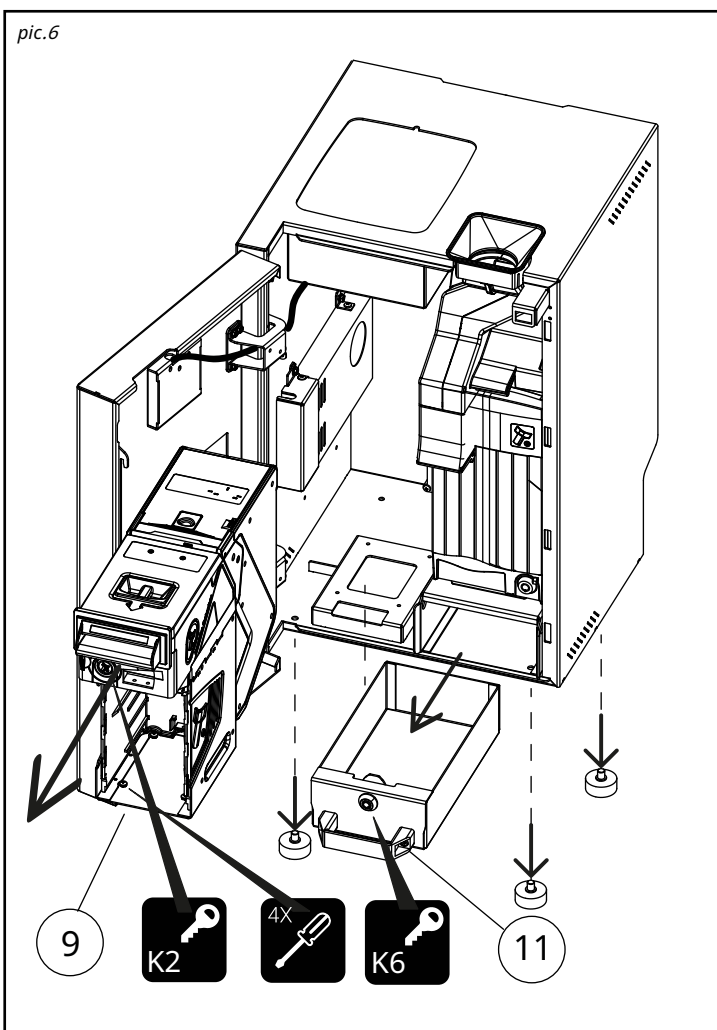

7.2 removal of internal modules

⚠ Before performing the operation, verify that the power is disconnected and that the case is placed stably on the support surface.

Extract the coin storage box (11) using the dedicated key, together with the NV200 module (9).

To remove the NV200 module from the case, disconnect the power and connection cables and use the appropriate key to extract the cashbox to gain access to the 4 fixing screws.

7. Installation

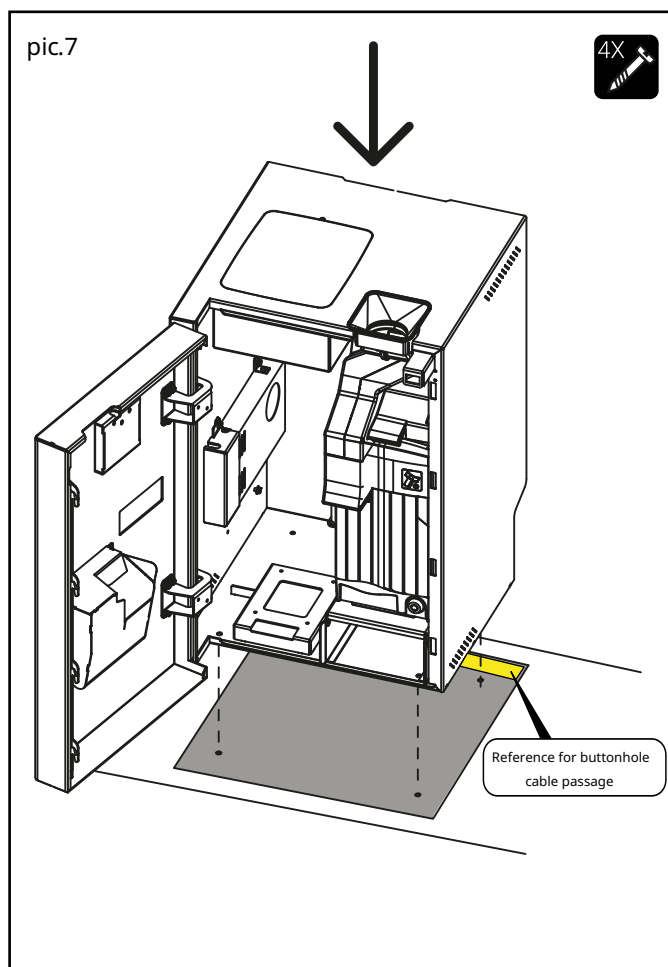

7.3 Fixing the case on the surface

Position the case on the surface where the holes were previously made using the template. Proceed with fixing the case. The diameter and type of screws to use depend on the support surface.

Once the fixing is complete, proceed to insert the box and the NV200 banknote module

Restore connections.

- ⚠ Check anchoring and stability.
- ⚠ It is recommended to connect the cables to the panel and route them in
in case it is difficult to reach them later.

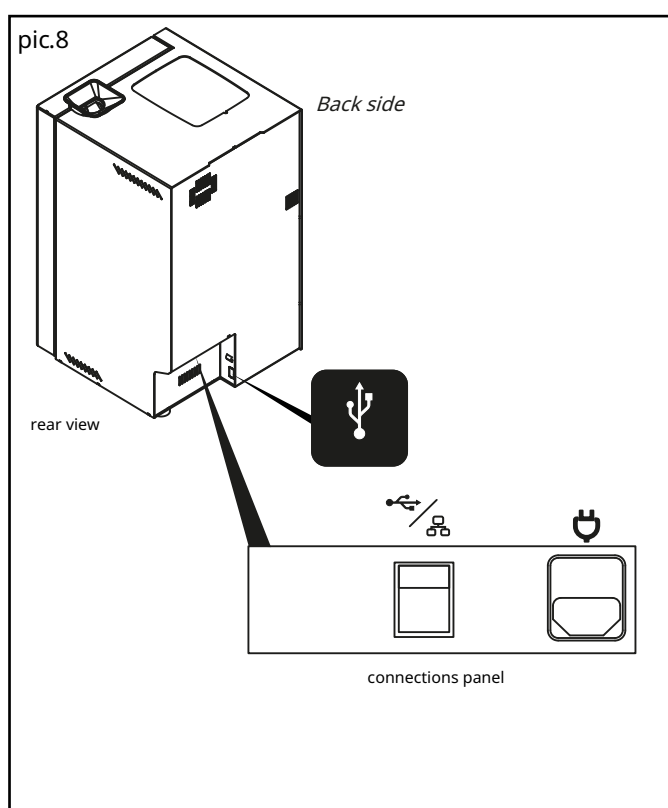

7.4 connections

Make the connections

- ⚠ Make sure that cables are routed in such a way as not to compromise safety, and that they are accessible.

For further details and information, consult the supplied user manual or contact assistance.



Assistance contacts

e. commercial@ditron.
t. +39 081242855 +39 0812428552
w. www.ditron.
a. Via Antiniana 115 - 80079 Pozzuoli (NA) - Ita

