

Safe money

ADVANCE/PLUS

Installation guide

index

1. Information.....	1
2. Security instructions.....	2
2.1 Skills.....	3
2.2 Cables.....	3
2.3 Temperature.....	3
2.4 Weight and modules.....	3
3. Presentation of the product.....	4
4. Product dimensions.....	5
5. Included parts.....	6
6. Main functions.....	7
7. Preparation for installation.....	8
8. Installation.....	10
8.1 Template guide.....	10
8.2 Case positioning.....	10
8.3 Built-in positioning.....	11
8.4 BNR mounting.....	11
8.5 Insert BNR.....	12
8.6 Insert smart coin system.....	13
8.7 Connections.....	13



1. Information

Please follow the above instructions for the machine installation and after sale service.
Thank you for choosing Ditron, visit www.ditron.eu for further information.

PRESERVE FOLLOWING INSTRUCTIONS

This manual contains important instructions to follow during installation and maintenance.

SafeMoney Advance has been projected to be installed in the existing operator desk.
More over to have access to the internal module some desk customization would be required.

This guide provides instructions for desk customizations to use banknote and coin validator.
Safemoney Advance has been developed for indoor installation.

The manufacturer cannot be responsible for damages or losses due to improper machine use .



The not properly installation of this products can generate injury or malfunctions, if above instructions are not respected.

2. Security instructions

Installation and removal

The installation and the machine removal must be done by an expert technician.

Warning:

Before to start after sale service or uninstallation of the product, be sure power supply is unplugged.

Warning:

Once Safemone Advance is installed, check every internal module is properly fixed to the chassis.

Warning:

After sale serve must be done by authorized personnel.



The SAFEmoney Advance complies with the following community electrical safety standards and electromagnetic compatibility.

Is provided with the following CE certifications

- EN 61000-6-1: 2019
- EN 61000-6-3: 2007 + A1
- EN 61000-3-2: 2019
- EN 61000-3-3: 2013+A1
- EN 62368-1:2020+A11
- EN 62233

2. Security instructions

2.1 SKILLS

Technical personel who will work with Electricity line, Machines and equipment must be well trained. Not authorized personel must not work with the above equipment if not under followed to an authorized technician.

2.2 Cables

⚠ SafeMoney Advance has internal battery used for running transaction closure only. It is strongly suggested to connect Safemoney Advance to an UPS to have more autonomy in case of power failure.

❗ Power cable is included

2.3 Temperature

Operating temperature

Temperature of the machine environment must be 0° and +40°C

Stock room temperature

Between -15° and +40°C

Humidity

[5%, 95%] no condense

Stock room humidity

[5%, 95%] no condense

2.4 Weight and parts (empty)

Metallic cabinet without the cash handling devices

Kg: 47

Metallic cabinet with Smart Coin system and BNR3

Kg: 70

Metallic cabinet with Smart coin system + BNR4

Kg: 70.4

Cash management devices

Bnr3 Kg: 23.6

Bnr4 Kg: 24.0 (ver. PLUS)

Smart coin system Kg: 4.1

3. Presentation of the product

- | | |
|------------------------|--|
| 1 - hole for eyebolt | 8 - BNR3 (ADVANCE) - BNR4 (ADVANCE PLUS) |
| 2 - banknote acceptor | 9 - smart coin system |
| 3 - banknote dispenser | 10 - connection pannel |
| 4 - coin acceptor | 11 - fan |
| 5 - touch display | 12 - frontal frame |
| 6 - coin dispenser | 13 - "hard reset" button |
| 7- door | 14 - extra coin deposit box |
| | 15 - rear holes for block |

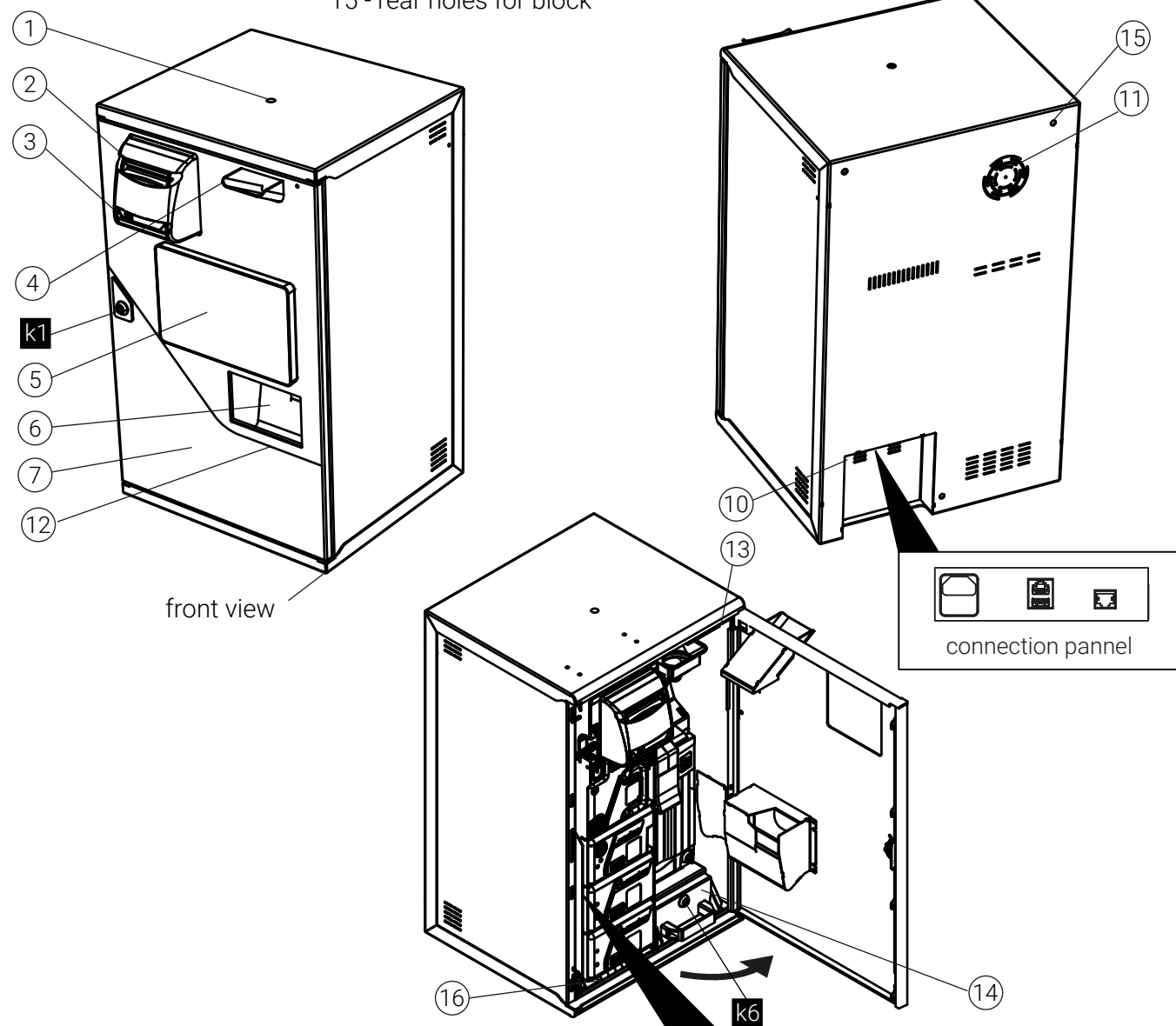

LOCKS

- k1: door key
- k2: cash box key
- k3: smart coin system block key
- k4: coin feeder release key
- k5: BNR module key
- k6: extra coin deposit box key

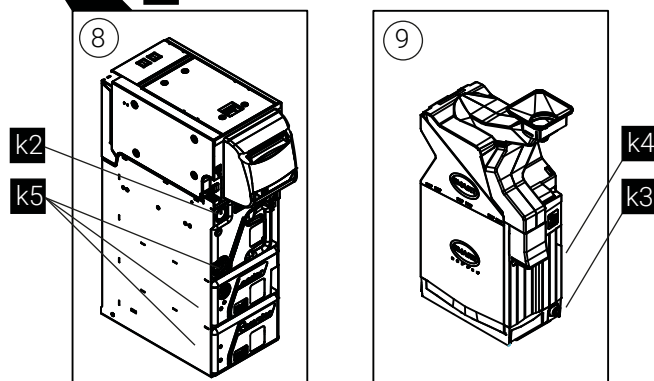

4. Product dimensions

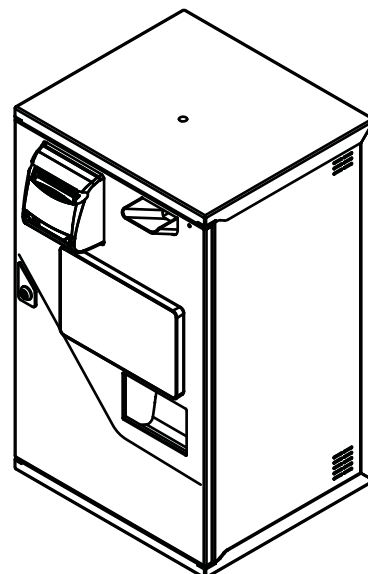
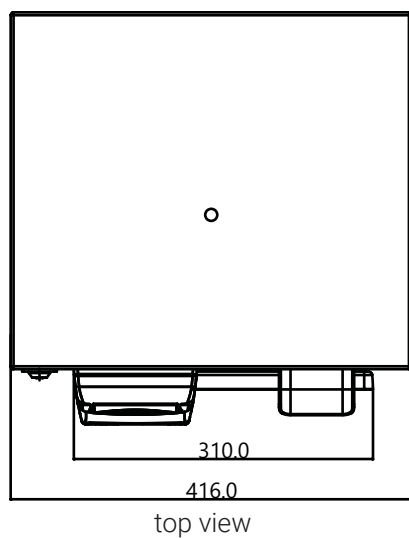
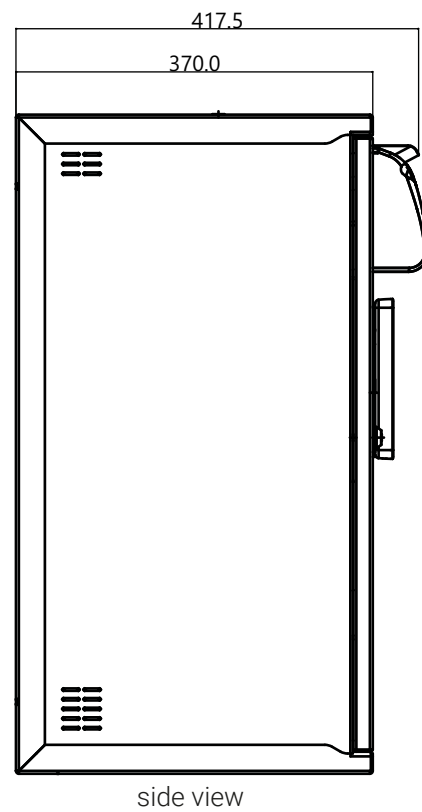
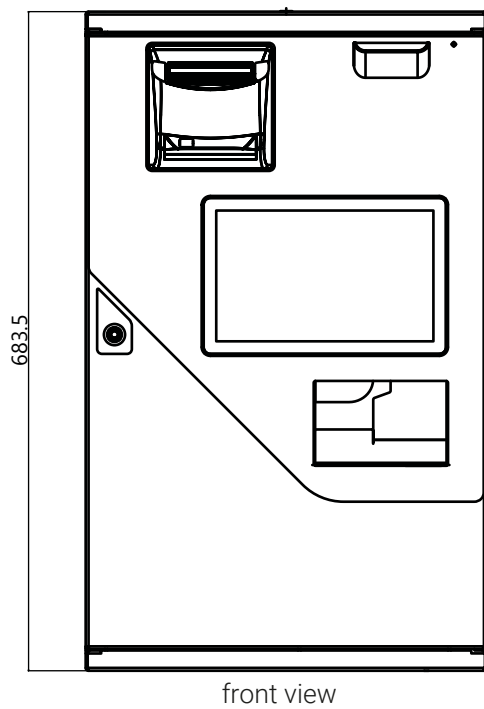
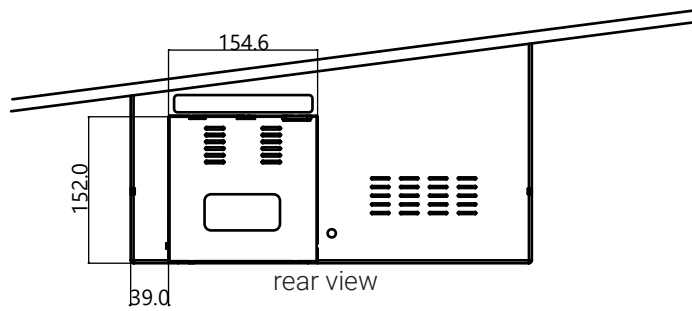

measurements expressed in mm (+ - 0.5 mm)

5. Included parts

BOX A

- 1 - case (cables, power supply and battery)
- 2 - keys
- 3 - power cable
- 4 - door adhesive
- 5 - SW activation key

BOX B

- 6 - smart coin system

BOX C

- 7 - cashbox and recycler (BNR4 for Advance PLUS)

BOX D

- 8 - main module validator

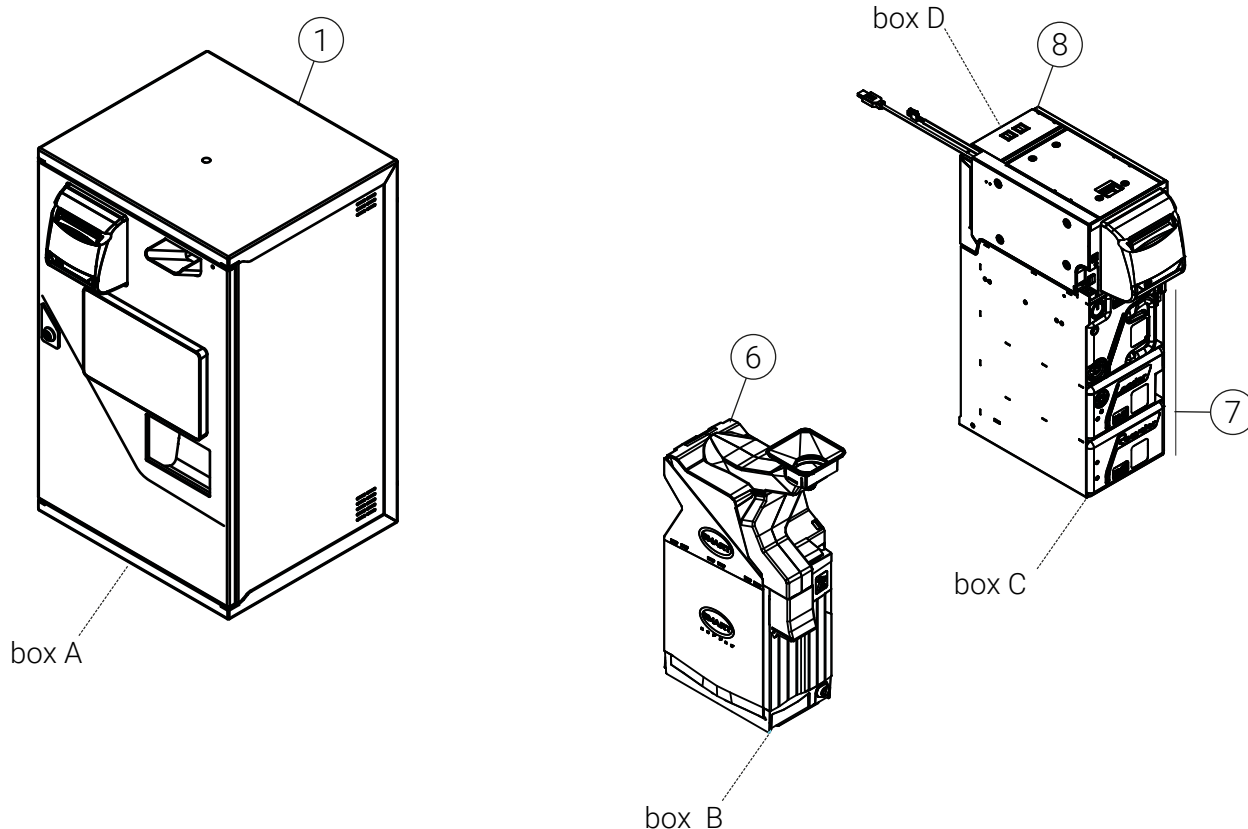

6. Main functions

COIN RECYCLING

Maximum insertion speed: bulk coin insertion "smart coin system"

Accepted coins: from € 0,01 to € 2,00

Maximum delivery speed: up to 6 coins / sec.

Capacity in recycle: 1500 mixed pieces in recycle

Cashbox for coin storage: 1.9L

BANKNOTES RECYCLING

Insertion: one by one

Accepted banknotes: from € 5.00 to € 500.00

Maximum delivery speed: up to 15 banknotes simultaneously (bulknote) - 1 banknote / 3 sec.

Capacity in recycle: up to 180 banknotes

Cashbox: up to 600 banknotes

Loader: up to 250 banknotes (PLUS version only)

GENERAL SPECIFICATIONS

Operator display: 10", graphic, touchscreen

Connections: ethernet

Power supply: 100-240 VAC - 2A - 50/60 Hz

backup power supply for completion of ongoing operation

Casing color: white

Dimensions (cm): W 41.6 x D 37 x H 68.4

Wight (kg) empty: 65

CONTROL AND MANAGEMENT

On board management

Multiple installation management

Platform management

Inter.com. through resful/API protocol

Inter. com. through protocol and le exchange, universal driver

Pre-set for management and control (diagnostics) via the Internet

On-site / online software update

Optional

Customizable front panel (min. 4 pieces)



For more details and information, consult user manual

7. Preparation for installation



Take desk measurements to guarantee the correct installation size. Refer to pag. 5.



Check the desk plan is able to support the machine and check if behind the machine there is some space for the fan flow.



Check the frontal door movement looking for any obstacle during the entire opening movement.



Check the cabinet is installed on a perfect horizontal desk.



Check if the desk is able to support Safemoney's weight



Check the desk composition.

To guarantee the perfect installation, SafeMeoney Advance must be installed screwing it to the desk using the 4 screws holes.



Some desk materials could not be suitable for the SafeMoney installation.



Check if the available shop space is enough for machine after sale service. It is mandatory remove the internal peripherals in case of safeMoney movements.*



Two persons are needed during the installation due to the weight and the dimension.



Check wall sockets are close enough and multiple power cords are not needed. Power cord can be dangerous for electroshock.

* the upper case has a support for eyebolt support.

7. Preparation for installation



Check the POS is located near to the SafeMoney Advance and the ETH cable is properly fixed.



Teach the users to the correct way to use the machine and check “dust zone” to exclude consequences related to dust and row materials near the SafeMoney Advance.



Check the safemoney distance to the floor is 40cm.

8. Installation

⚠ Warning: It is mandatory to screw the SafeMoney to the desk. Use the guide support in the box for the screws holes.

Un-box the machine and check steps in "Installation requirements". Then Go on with the installation.

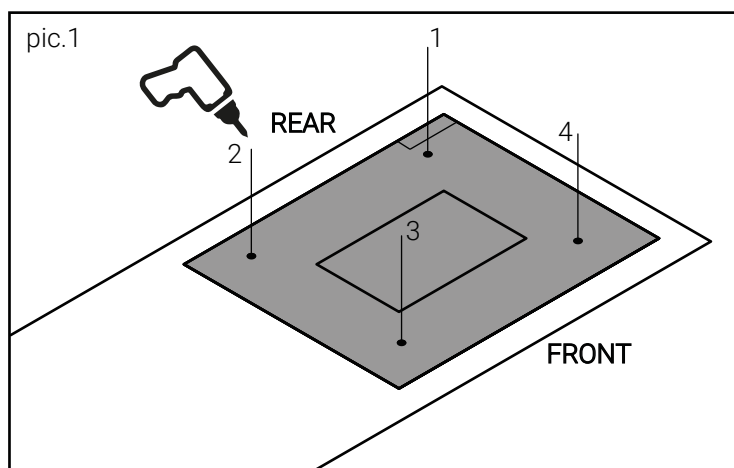

8.1 Template guide

Put the template guide on the desk and fix it with adhesive. Use the drill to make the 4 holes. Pay attention to the template guide side. (front and back side)

If necessary, create a button hole for cables referring to the connection panel on the template guide.

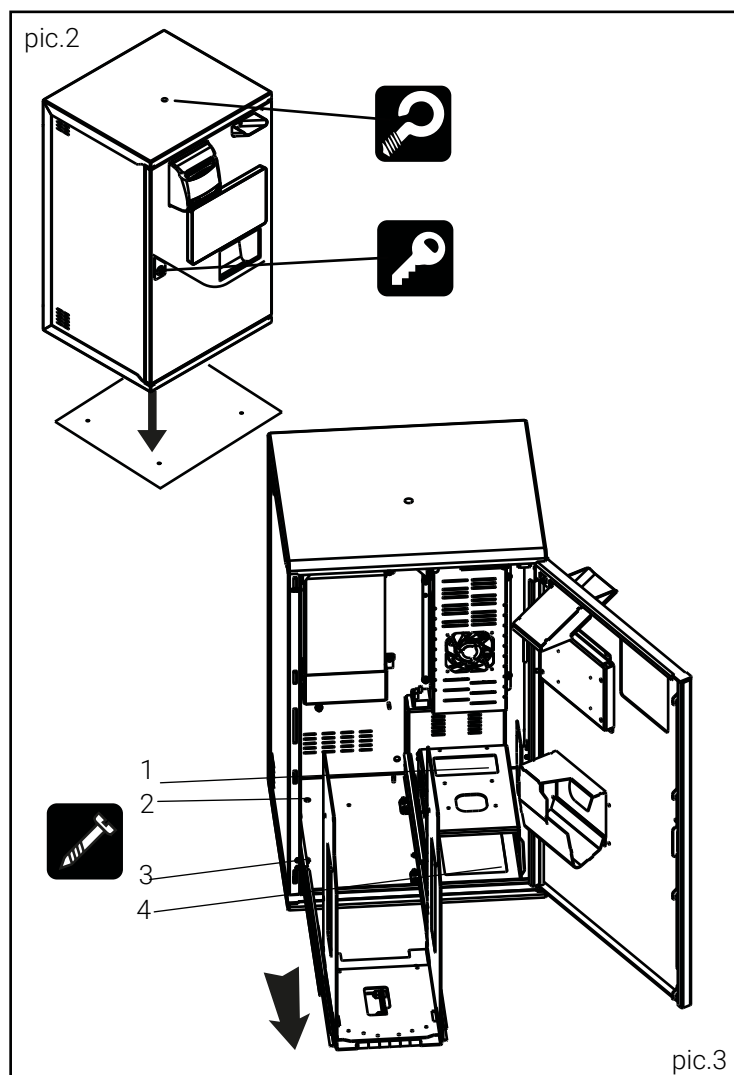

8.2 Case positioning

Due to the heavy weight it is suggested to move the machine with 2 persons or using some mechanical equipment.

Open the frontal door using the key (k1) and extract the BNR support to have the access to the screws holes.

Using an electric screwdriver to screw the SafeMoney to the desk.

Holes on the back of the case (see pg. 4) can be used to fix the machine if it is not possible to screw it to the top.

⚠ Also in this configuration, the product must be placed on a horizontal plane.

⚠ Check fixing and stability.

8. Installation

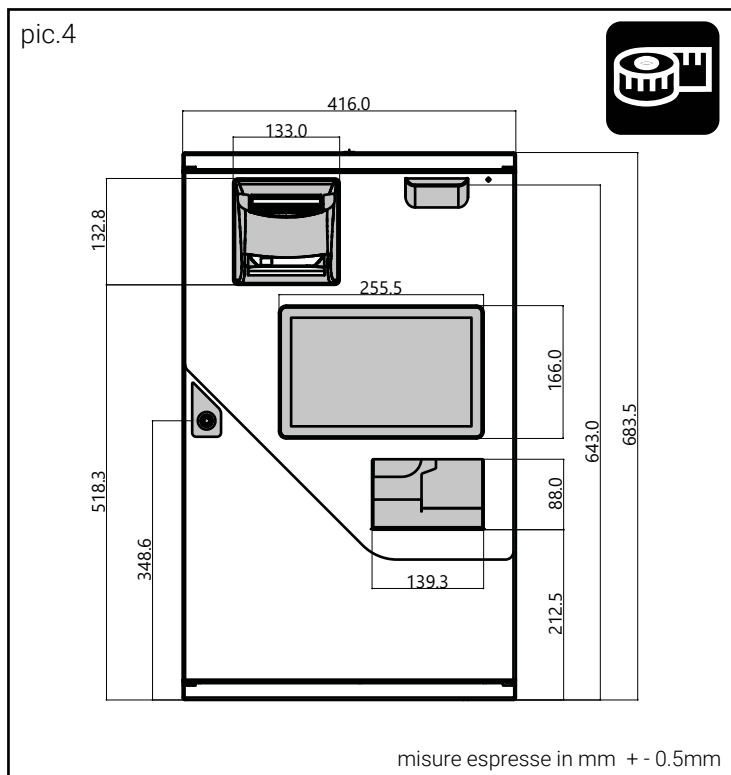

8.3 Built-in positioning

SafeMoney Advance has been projected to be installed into the pre-existent desk with peripherals to the customer or the operator.

For this layout it is necessary to customize the desk in order to have the access to the peripherals. Pic n.4 shows measurement to threat to perform the above holes.

⚠ Check the SafeMoeney Advance has enough space for air flew

⚠ It is recommended to drive cables to the connection panel if the access is not easily accessible.

⚠ Check the desk materials are suitable for the installation.

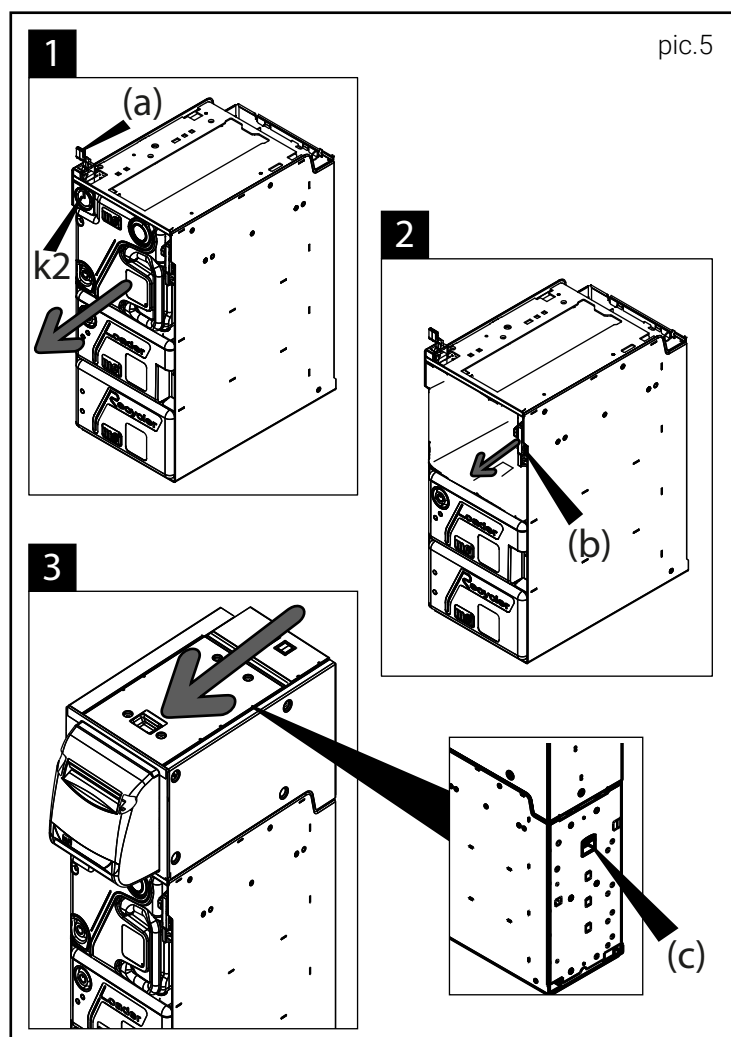

8.4 BNR mounting

Unbox the Main module and cashbox\recycler

- 1) Extract the cash box and unblock it using key 2 then take down the yellow lever(a).
- 2) Extract the cashbox then move the green lever to the external part (b).
- 3) Insert the validator pushing it as shown in the pic. 5.

This operation must be done with the spinmodule (in the back) o
Opened. Use the yellow lever.(c)

8. Installation

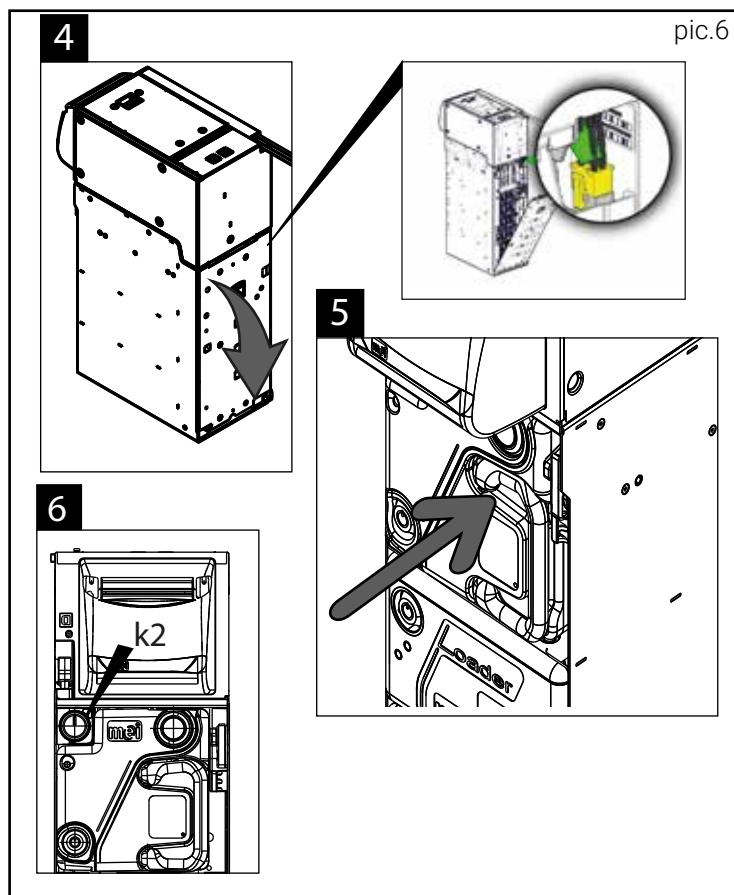

8.4 BNR mounting

- 4) Connect the cables.
- 5) Arm the cash box module (open and close it) then insert it in the related space.
- 6) Close using the key k2 then lift up the green lever.

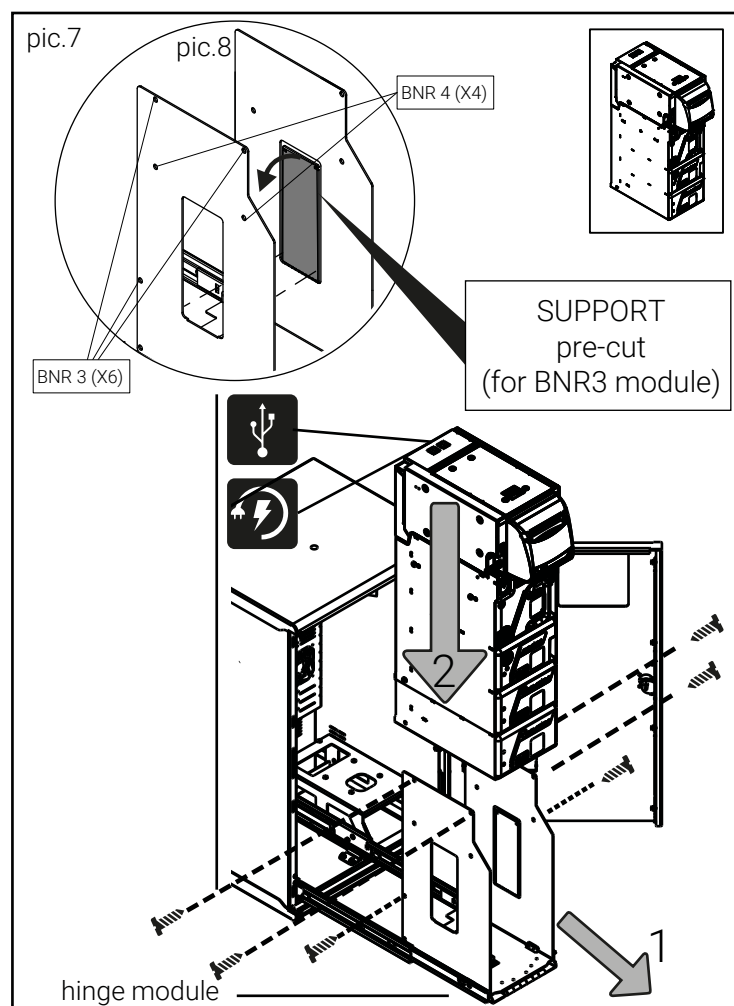

8.5 Insert BNR

BNR3 ver. ADVANCE

BNR4 ver. ADVANCE PLUS

⚠ Before starting to connect the cashbox and recyclers, check the machine is not connected to the power supply and it is properly secured.

- (1) Extract the BNR support.
- (2) Put the BNR module on it.
ONLY for BNR3 (ADVANCE)
fold the metallic support as shown in pic.8.
- (3) Align the 3 holes with the bnr holes then secure it using M5X8 screws (x6)
- (4) Connect the usb cable and the power cable to the BNR.

Drive the cable properly to not obstacle the BNR movements.

Ground cable is already connected. There is no need to connect the BNR ground cable.

8. Installation

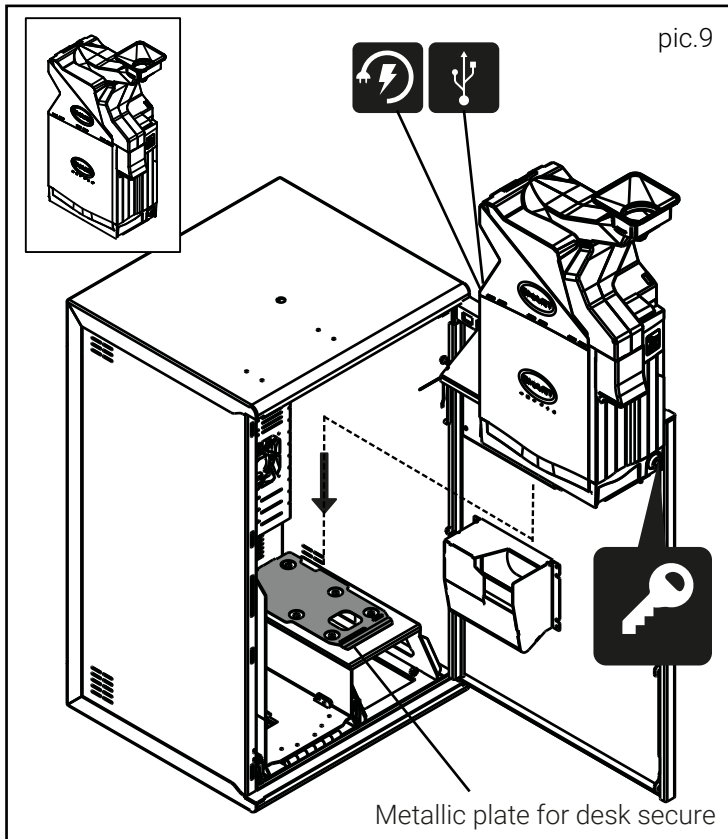

8.6 Insert smart coin system

⚠ Unbox smart coin system module then using the keys secure it to the metallic platform.

Unbox smart coin system module then using the keys secure it to the metallic platform.

Connect the cables.

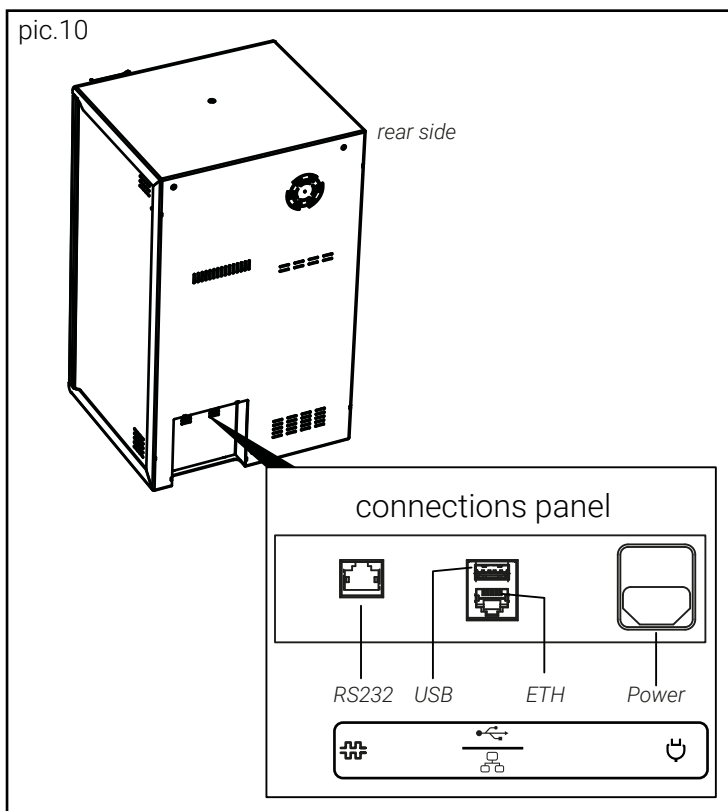

8.7 connections

Connect the cables

⚠ Check cables are properly connected and they are not exposed to the user.

For further information check safemoney manual or contact after sale service.



Ditron 
group

 Assistance contacts

e. commercial@ditron.eu

t. +390812428557

w. www.ditron.eu

